

# Hoist Ring to Chain or Webbing

**Load Rated**



**SEE APPLICATION AND WARNING INFORMATION**

Para Español: [www.thecrosbygroup.com](http://www.thecrosbygroup.com)

On Pages 182-184

## HR-125C



- Available in capacities from 2 to 8.2 tonnes.
- Fits Grade 8 Chain size 7, 8, 10, 13 and 16mm.
- Forged Alloy Steel.
- Design factor of 4 to 1.
- Individually Proof Tested to 2-1/2 times Working Load Limit.
- "Yellow Chromate" finish for increased corrosion protection.
- Full 360 degrees swivel and 180 degrees pivot action.
- Bolt specification is a Grade 8 Alloy socket head cap screw to ASTM A574. All threads are UNC.
- All sizes are **RFID EQUIPPED**.

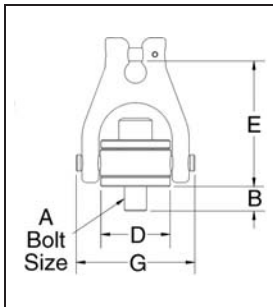

## HR-125C Hoist Ring to Chain

HR-125C Stock No.	Working Load Limit (t)*	Torque in Ft.-Lbs.	Effective Thread Projection Length (mm)	Spectrum 8 Chain Size (in. - mm)	Dimension (mm)					Weight Each (kg)
					UNC Thread A ‡	B	D	E	G	
1067492	2	60	18.0	1/4-5/16 7-8	5/8-11 x 2.00	17.8	49.8	90.0	85.0	.95
1067494	2	60	37.1	1/4-5/16 7-8	5/8-11 x 2.75	30.5	49.8	90.0	85.0	.95
1067500	3.2	100	22.9	3/8 10	3/4-10 x 2.75	22.6	75.0	121	124	2.45
1067502	3.2	100	41.9	3/8 10	3/4-10 x 3.50	41.7	75.0	121	124	2.45
1067509	5.4	230	29.2	1/2 13	1-8 x 3.00	29.0	75.0	122	124	2.90
1067511	5.4	230	54.6	1/2 13	1-8 x 4.00	54.5	75.0	122	124	3.04
1067518	8.2	470	56.4	5/8 16	1-1/4-7 x 4.50	56.0	94.0	166	157	5.81

\* Ultimate load is 4 times the Working Load Limit. Individually tested to 2-1/2 the Working Load Limit.

‡ Long Bolts are designed to be used with soft metal (i.e., aluminum) work piece. While the long bolts may also be used with ferrous metal (i.e., steel & iron) work piece, short bolts are designed for ferrous work pieces only.

**Load Rated**

## HR-125W



U.S. Patent No. 5,927,780

- Available in capacities from 2.8 to 5.6t.
- Fits webbing sizes 50 to 100mm.
- Forged Alloy Steel
- Durable plastic cover protects the sling at the eye as well as keeps the sling positioned correctly on the spool.
- Bolt specification is a Grade 8 Alloy socket head cap screw to ASTM A574. All threads are UNC.
- Design Factor of 5 to 1.
- Individually Proof Tested to 2-1/2 times the Working Load Limit.
- Designed for use with Type III (Eye & Eye), class 7, 2 ply webbing & synthetic round slings. Also accommodates single ply endless slings.
- All sizes are **RFID EQUIPPED**.

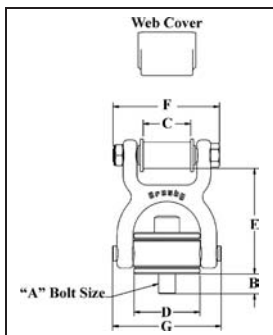

## HR-125W Hoist Ring to Web

HR-125W Stock No.	Round Sling Size (No.)	Web Width (mm)	Eye Width (mm)	Working Load Limit (t)*	Torque in Ft.-lbs.	Eff. Thread Proj. Length (mm)	Spool bolt & nut Torque in Ft.-Lbs.	Dimension (mm)							Weight Each (kg)
								UNC Thread A ‡	B	C	D	E	F	G	
1067610	1 & 2	50	50	2.8	100	22.9	90	3/4-10x2.75	22.6	54.0	75.0	121	121	124	2.81
1067615	1 & 2	50	50	2.8	100	41.9	90	3/4-10x3.50	41.7	54.0	75.0	121	121	124	2.86
1067629	3	75	35	4.0	230	29.2	110	1-8x3.00	29.0	41.4	75.0	121	115	124	3.22
1067634	3	75	35	4.0	230	54.6	110	1-8x4.00	54.5	41.4	75.0	121	115	124	3.31
1067638	4	100	50	5.6	470	56.4	130	1-1/4-7x4.5	56.0	54.0	94.0	158	109	157	6.21

\* Ultimate load is 5 times the Working Load Limit. Individually tested to 2-1/2 times the Working Load Limit.  
‡ Long Bolts are designed to be used with soft metal (i.e., aluminum) work piece. While the long bolts may also be used with ferrous metal (i.e., steel & iron) work piece, short bolts are designed for ferrous work pieces only.